

UNIT, DIRECT SUPPORT, AND GENERAL SUPPORT MAINTENANCE
REPAIR PARTS AND SPECIAL TOOLS LIST
TRUCK, 5-TON, 6X6, M809 SERIES TRUCKS (DIESEL)

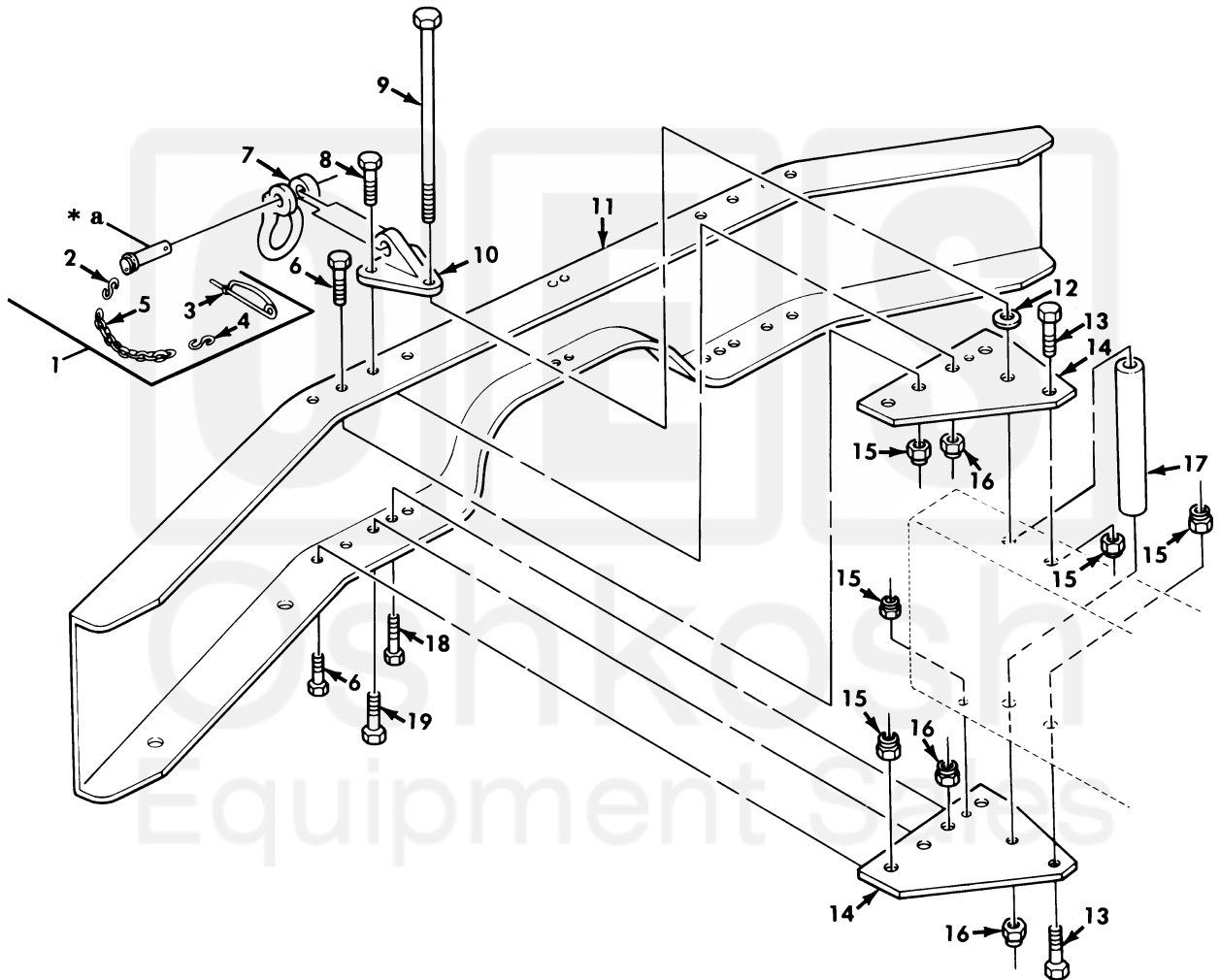

* a PART OF ITEM 1

Figure 227. Front Bumper, Lifting Shackle, Step, and Mounting Hardware.

(1) ITEM NO	(2) SMR CODE	(3) NSN	(4) CAGEC	(5) PART NUMBER	(6) DESCRIPTION AND USABLE ON CODE (UOC)	(7) QTY
GROUP 1501 FRAME ASSEMBLY						
FIG. 227 FRONT BUMPER, LIFTING SHACKLE, STEP, AND MOUNTING HARDWARE						
1	PAOZZ	5315-00-741-2924	19207	7412924	PIN, STRAIGHT, HEADED.....	2
2	PAOZZ	4030-00-999-4048	96906	MS87006-41	.HOOK, CHAIN, S.....	1
3	PAOZZ	5315-00-741-8971	19207	7418971	.PIN, RETAINING.....	1
4	PAOZZ	4030-00-948-7315	96906	MS87006-33	.HOOK, CHAIN, S.....	1
5	MOOZZ		80244	42-C-15120-205	.CHAIN MAKE FROM CHAIN, P/N 819906..	1
6	PAOZZ	5305-00-719-5219	96906	MS90727-111	SCREW, CAP, HEXAGON H.....	8
7	PAOZZ	4030-01-222-6037	19207	12301040	SHACKLE, STIRRUP.....	2
8	PAOZZ	5305-00-726-2551	80204	B1821BH063F200N	SCREW, CAP, HEXAGON H.....	4
9	PAOZZ	5305-00-740-9507	19207	10883119	SCREW, CAP, HEXAGON H.....	2
9	PAOZZ	5305-00-140-4765	19207	10883118	SCREW, CAP, HEXAGON H.....	2
					UOC: 614, 620, 621, 623, 624, 625, 626, 627, 628, 629, 630, 631, 632, 633, 634, 635, 637, 638	
					UOC: 622	
10	PAOZZ	5340-01-315-8921	19207	12368440	BRACKET, T FRONT BUMPER.....	2
11	PAOZZ	2540-00-737-6203	19207	7376203	BUMPER, VEHICULAR.....	1
12	PFOZZ	5310-00-521-4534	19207	5214534	WASHER, FLAT.....	2
13	PAOZZ	5305-00-725-4183	96906	MS90726-113	SCREW, CAP, HEXAGON H.....	2
					UOC: 622	
13	PAOZZ	5305-00-725-4183	96906	MS90726-113	SCREW, CAP, HEXAGON H.....	4
					UOC: 614, 620, 621, 623, 625, 628, 633, 634, 637	
13	PAOZZ	5305-00-719-5219	96906	MS90727-111	SCREW, CAP, HEXAGON H FRONT BUMPER	4
					PLATE.....	
					UOC: 624, 626, 627, 629, 630, 631, 632, 635, 638	
14	PFOZZ	2510-00-407-5084	19207	10883113	PLATE, VEHICLE BUMPE.....	4
15	PAOZZ	5310-00-062-4954	96906	MS21045-8	NUT, SELF-LOCKING, HE.....	16
					UOC: 614, 620, 621, 623, 624, 625, 626, 627, 628, 629, 630, 631, 632, 633, 634, 635, 637, 638	
15	PAOZZ	5310-00-062-4954	96906	MS21045-8	NUT, SELF-LOCKING, HE.....	12
					UOC: 622	
16	PAOZZ	5310-00-982-5009	96906	MS21045-10	NUT, SELF-LOCKING, HE.....	10
17	XDOZZ		19207	7409524	PIPE, METALLIC.....	2
18	PAOZZ	5305-00-725-4183	96906	MS90726-113	SCREW, CAP, HEXAGON H PART OF KIT P/N	2
					12300799.....	
19	PAOZZ	5305-00-727-2283	80204	B1821BH063F150N	SCREW, CAP, HEXAGON H.....	4

END OF FIGURE

UNIT, DIRECT SUPPORT, AND GENERAL SUPPORT MAINTENANCE
REPAIR PARTS AND SPECIAL TOOLS LIST
TRUCK, 5-TON, 6X6, M809 SERIES TRUCKS (DIESEL)

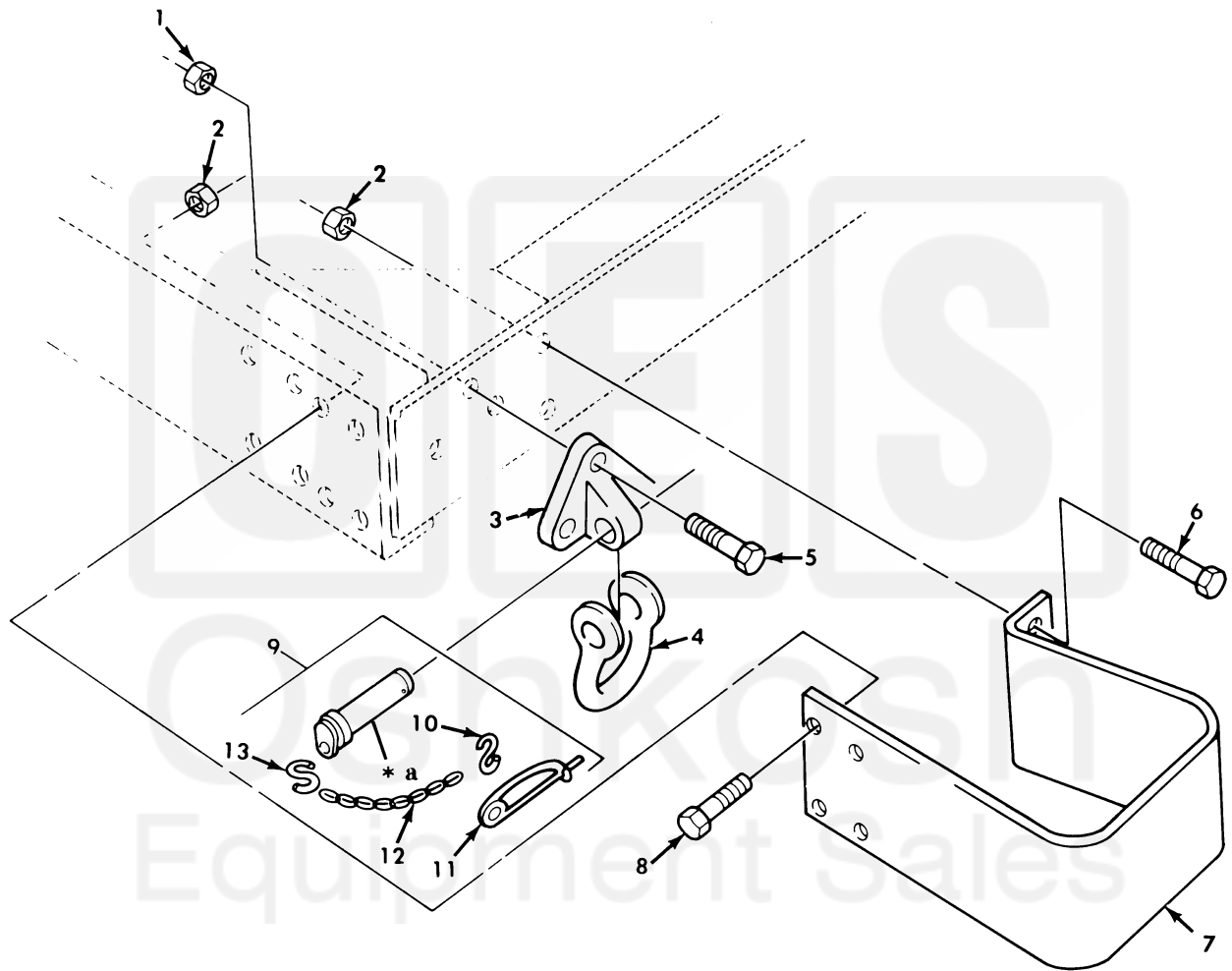

*** a PART OF ITEM 9**

Figure 228. Rear Bumperette and Shackle Assembly.

(1) ITEM NO	(2) SMR CODE	(3) NSN	(4) CAGEC	(5) PART NUMBER	(6) DESCRIPTION AND USABLE ON CODE (UOC)	(7) QTY
GROUP 1501 FRAME ASSEMBLY						
FIG. 228 REAR BUMPERETTE AND SHACKLE ASSEMBLY						
1	PAOZZ	5310-00-982-5009	96906	MS21045-10	NUT, SELF-LOCKING, HE.....	6
2	PAOZZ	5310-00-062-4954	96906	MS21045-8	NUT, SELF-LOCKING, HE.....	12
						UOC: 614, 623, 624, 625, 626, 628, 629, 637, 638
2	PAOZZ	5310-00-062-4954	96906	MS21045-8	NUT, SELF-LOCKING, HE.....	8
						UOC: 620, 621, 630, 631, 632
3	PAOZZ	5340-01-315-8921	19207	12368440	BRACKET, T.....	2
4	PAOZZ	4030-01-316-2554	19207	12368441	SHACKLE.....	2
5	PAOZZ	5305-00-726-2550	80204	B1821BH063F175N	SCREW, CAP, HEXAGON H.....	6
6	PAOZZ	5305-00-725-4183	96906	MS90726-113	SCREW, CAP, HEXAGON H.....	4
						UOC: 620, 621, 630, 631, 632
6	PAOZZ	5305-00-725-4183	96906	MS90726-113	SCREW, CAP, HEXAGON H.....	8
						UOC: 614, 623, 624, 625, 626, 628, 629, 637, 638
7	PFOZZ	2540-00-693-0676	19207	8333329	BUMPER, VEHICULAR.....	2
8	PAOZZ	5305-00-719-5235	80204	B1821BH050F175N	SCREW, CAP, HEXAGON H.....	4
9	PAOZZ	5315-00-741-2924	19207	7412924	PIN, STRAIGHT, HEADED.....	2
10	PAOZZ	4030-00-948-7315	96906	MS87006-33	.HOOK, CHAIN, S.....	1
11	PAOZZ	5315-00-741-8971	19207	7418971	.PIN, RETAINING.....	1
12	MOOZZ		16003	C43974 X 6	.CHAIN, WELDLESS MAKE FROM CHAIN, P/N 819906.....	1
13	PAOZZ	4030-00-999-4048	96906	MS87006-41	.HOOK, CHAIN, S.....	1

END OF FIGURE

